

---

# ***Printing System (M)***

## —— CONTENTS ——

FIG.1 PRINTING SYSTEM.....	2
----------------------------	---

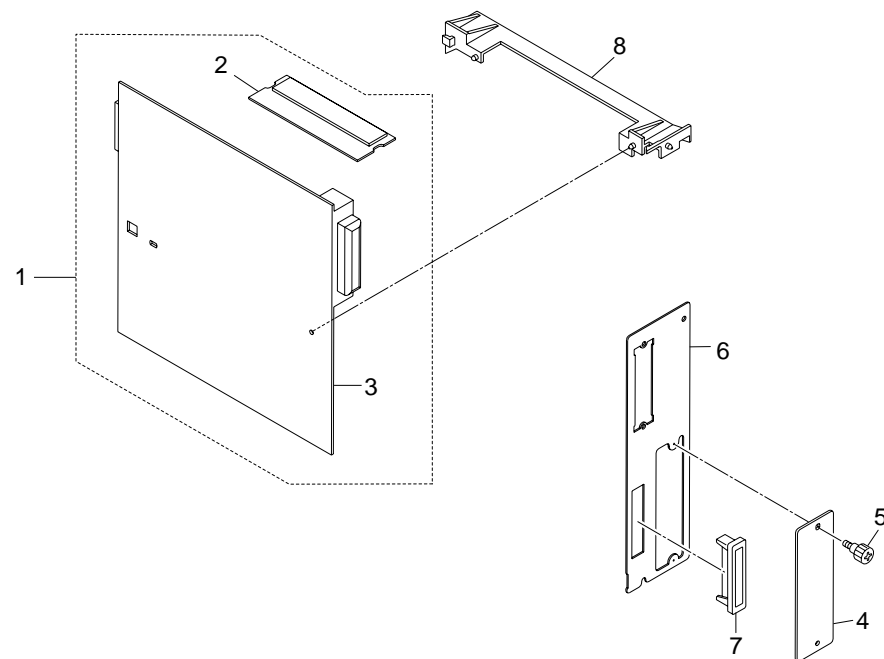

FIG. 1 PRINTING SYSTEM

3BM

SP	Ref. No.	Part. No.	Description	Quantity		
				120V	230V	240V
	1	3BM01010	PRINTER CONTROL PCB ASS'Y	1	1	1
	2	•3BM68010	CODE ROM SERVICE PCB	1	1	1
	3	•3BM28010	PRINTER CONTROL PCB	1	1	1
	4	2AV26240	READ LID,SHIELD	1	1	1
	5	3BH26030	PIN,OPTION	1	1	1
	6	3BK26010	MOUNT,PRINTER BOARD	1	1	1
	7	3BK26020	GUIDE,CF	1	1	1
	8	3BK26030	RAIL,OPTION	1	1	1

- Parts with "•" are component parts or sub-assemblies of the assembly appearing immediately above them.
- Parts with "●" indicates the Service parts.

- Parts with "••" are component parts or sub-assembly with "•" appearing immediately above them.